

St. Cloud State University

The Repository at St. Cloud State

Programs and Other Publications

Winter Institute

2-9-1996

Winter Institute Program [1996]

St. Cloud State University

Follow this and additional works at: https://repository.stcloudstate.edu/wintint_progs

Recommended Citation

St. Cloud State University, "Winter Institute Program [1996]" (1996). *Programs and Other Publications*. 33. https://repository.stcloudstate.edu/wintint_progs/33

This Book is brought to you for free and open access by the Winter Institute at The Repository at St. Cloud State. It has been accepted for inclusion in Programs and Other Publications by an authorized administrator of The Repository at St. Cloud State. For more information, please contact tdsteman@stcloudstate.edu.

THE CENTER FOR ECONOMIC EDUCATION
AND THE SCSU STUDENT GOVERNMENT
ANNOUNCE

34th Annual

ECONOMIC EDUCATION WINTER INSTITUTE



**Friday, February 9, 1996
Atwood Center Ballroom
St. Cloud State University**

ST. CLOUD STATE
UNIVERSITY

Center for Economic Education

388 Stewart Hall
720 Fourth Avenue South
St. Cloud, MN 56301-4498

PROGRAM

a.m.

- 8:30 REGISTRATION
Atwood Center Ballroom
- 9:00 GREETINGS AND INTRODUCTIONS
Bruce F. Grube, President, St. Cloud State University
Amy Nord, Chair, SCSU Student Government
Senate Finance Committee
- 9:05 "The Future of Social Security,"
Edward M. Gramlich
- 10:15 BREAK
- 10:30 "The Fiscal Nightmare Facing Baby Boomers
and Their Children,"
Laurence J. Kotlikoff
- 11:45 CLOSING AND THANK YOU

p.m.

- 12:00 BUFFET LUNCH (reservations required)
- 1:00 VIRTUAL ECONOMICS: AN INTERACTIVE
CENTER FOR ECONOMIC EDUCATION, CD-
ROM WORKSHOP
Workshop Leaders—
Richard MacDonald, Director of the St. Cloud
State University Center for Economic Education
Invited teachers only
- 3:30 ADJOURN

OBJECTIVES

- To increase interest in economic education
- To provide an opportunity for interaction with leaders in economics and education
- To encourage the integration of economic concepts in the school curricula
- To present economic subject matter that will be interesting and useful for all who attend

The Economic Education Winter Institute is presented as a service to:

Students at SCSU
University/college faculty and administrators
Elementary/secondary teachers and administrators
Regional SCSU alumni
Minnesota Council on Economic Education affiliates
General public

SPONSORING ORGANIZATIONS

SCSU Center for Economic Education
SCSU Student Government
Minnesota Council on Economic Education
St. Cloud State University's
College of Education
College of Social Sciences
Economics department
Interdisciplinary studies department
St. Cloud State University Foundation

The SCSU Center for Economic Education is an affiliate of the Minnesota Council on Economic Education (MCEE) and the National Council on Economic Education (NCEE). The center offers in-service and pre-service for-credit workshops, short courses, and traditional courses in the area of economics for K-12 educators. The center also offers a variety of non-credit workshops and programs that appeal to broader audiences. In addition to the Winter Institute, the center organizes an annual economic outlook program and sponsors the Minnesota Heartland Economics Challenge, an economics quiz bowl for high school students from Central Minnesota schools. For more information about these and other economic education programs, call our office at 612-255-2157 or write us at the address provided on the back of the brochure.

Prepared by the Office of Public Relations & Publications and by Printing Services. SCSU is an affirmative action/equal opportunity educator and employer. This material can be given to you in an alternative format such as large print, Braille, etc., by contacting the department/agency listed elsewhere on this brochure.

MAP

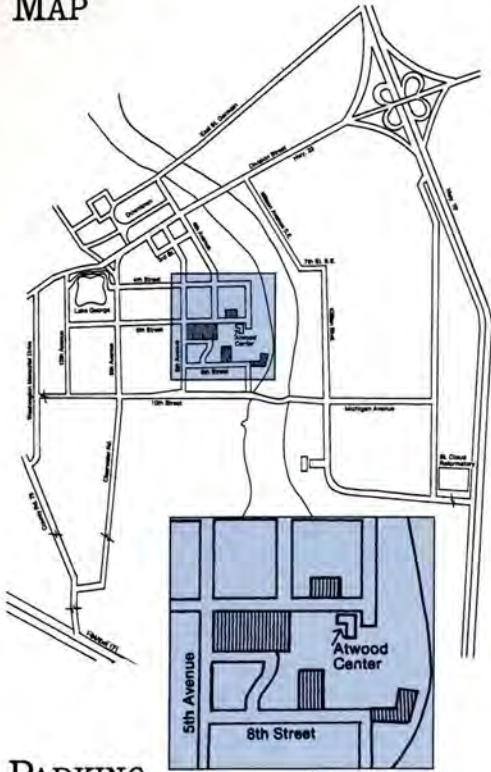

PARKING

Parking is available in student lots and on public streets near the campus. Parking permits may be obtained upon written request to the Center for Economic Education by January 26. Parking lots are indicated by shaded areas on the campus map above. Shuttle bus service is available for lots K and Q at 10-minute intervals. Call the Center for Economic Education for more details, (612) 255-2157.

This program has been recommended for teacher renewal credits.

SPEAKERS



Edward Gramlich, Ph.D., is Dean of the School of Public Policy at the University of Michigan. He is professor of economics and public policy there, and he also has served as chair of the economics department. In 1994 he was appointed chair of the Quadrennial Advisory Council on Social Security. The council is charged with

examining the long-range financial status of the social security program.

In 1986 and 1987 Dr. Gramlich served as deputy and then as acting director of the Congressional Budget Office, a nonpartisan congressional agency charged with analyzing budgets and other policy questions. He also has served with the Federal Reserve Board, the Office of Economic Opportunity, the Brookings Institution, and in 1992 was the staff director for the Economic Study Commission of major league baseball. He currently is in his second edition of a popular text on cost-benefit analysis, and has written several other books and many articles on topics such as macroeconomics, budget policy, income redistribution, fiscal federalism, social security and the economics of professional sports.



Laurence J. Kotlikoff, Ph.D., is professor of economics at Boston University, research associate of the National Bureau of Economic Research, and Fellow of the Econometric Society. He received his B.A. in economics from the University of Pennsylvania in 1973 and his Ph.D. in economics from Harvard University in 1977. From

1977 through 1983 he served on the faculties of economics departments of the University of California - Los Angeles and Yale University. In 1981-82 Professor Kotlikoff was a senior economist with the President's Council of Economic Advisers. Professor Kotlikoff has served as a consultant to the International Monetary Fund, the World Bank, the Organization for Economic Cooperation and Development, the Swedish Ministry of Finance, the Norwegian Ministry of Finance, the Bank of Italy, the Bank of Japan, the Government of Bolivia, the Treasury of New Zealand, the Office of Management and Budget, the U.S. Department of Education, the U.S. Department of Labor, the Joint Committee on Taxation, The American Council of Life Insurance, Merrill Lynch, Fidelity Investments, and other major U.S. corporations. He has provided expert testimony on numerous occasions to committees of Congress including the Senate Finance Committee, the House Ways and Means Committee and the Joint Economic Committee. Professor Kotlikoff is co-author (with Alan Auerbach) of *Macroeconomics: An Integrated Approach*, author of *Generational Accounting, What Determines Savings?*, co-author (with Alan Auerbach) of *Dynamic Fiscal Policy*, co-author (with Daniel Smith) of *Pensions in the American Economy*, and co-author (with David Wise) of *The Wage Carrot and the Pension Stick* and has published extensively in professional journals, newspapers and magazines on issues of deficits, generational accounting, the tax structure, social security, pensions, savings and insurance.

No program registration fee.

Luncheon \$6.95/Reservations are required by January 26, 1996. Make check payable to: Center for Economic Education.

REGISTRATION

Please complete this form and return by January 26, 1996

Name _____

Address _____

City _____ State _____ ZIP _____

Indicate your preference:

I plan to attend the Winter Institute and the luncheon. (Enclose \$6.95 for each luncheon reservation you desire.)

I plan to attend the Winter Institute but not the luncheon. (No registration fee.)

Total \$ _____

Print guest names here for luncheon reservations.

Send to:

Center for Economic Education
388 Stewart Hall
St. Cloud State University
720 Fourth Avenue South
St. Cloud, MN 56301-4498

Phone: (612) 255-2157

TDD/TTY: The Minnesota Relay Service
(612) 297-5353 or 1-800-627-3529