

St. Cloud State University

The Repository at St. Cloud State

Programs and Other Publications

Winter Institute

2-25-2000

Winter Institute Program [2000]

St. Cloud State University

Follow this and additional works at: https://repository.stcloudstate.edu/wintint_progs

Recommended Citation

St. Cloud State University, "Winter Institute Program [2000]" (2000). *Programs and Other Publications*. 37. https://repository.stcloudstate.edu/wintint_progs/37

This Book is brought to you for free and open access by the Winter Institute at The Repository at St. Cloud State. It has been accepted for inclusion in Programs and Other Publications by an authorized administrator of The Repository at St. Cloud State. For more information, please contact tdsteman@stcloudstate.edu.

ST. CLOUD STATE UNIVERSITY
A tradition of excellence and opportunity
CENTER FOR ECONOMIC EDUCATION
Stewart Hall 373
720 Fourth Avenue South
St. Cloud, MN 56301-4498

THE CENTER FOR ECONOMIC EDUCATION
&
THE SCSU STUDENT GOVERNMENT
A N N O U N C E

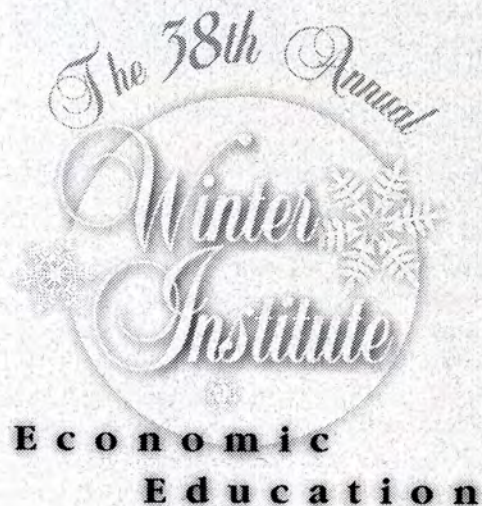

*"The New Economy: Recent and Future
Developments in the Changing Economy"*

Friday, February 25, 2000
Atwood Center Ballroom
St. Cloud State University

Program

8:30 a.m.	REGISTRATION Atwood Center Ballroom
9:00	GREETINGS AND INTRODUCTIONS Ali R. Malekzadeh , Vice President for Academic Affairs, St. Cloud State University Arthur J. Rolnick , Chair, Minnesota Council on Economic Education Chair, SCSU Student Government Senate Finance Committee "Relative Wages in the 1990s" Kevin M. Murphy
9:10	
10:15	"The New Economy: You Ain't Seen Nothing Yet" Chris Farrell
11:20	CLOSING AND THANK YOU
11:30	BUFFET LUNCH (\$7.50) Reservations are required by February 16
12:30	FOCUS: LEARNING FROM THE MARKET: INTEGRATING THE STOCK MARKET GAME ACROSS THE CURRICULUM Workshop Leaders—Gail Funk Colbert, St. Paul Tartan High School, and Bonnie Vagasky, Business Economic Education Foundation <i>Invited Teachers Only</i>
3:30	ADJOURN

Sponsoring Organizations

- SCSU Center for Economic Education
- SCSU Student Government Senate Finance Committee
- Minnesota Public Radio
- Minnesota Council on Economic Education
- SCSU Foundation
- SCSU Harold E. Anderson Entrepreneurial Center
- St. Cloud State University's
 - College of Social Sciences
 - Economics Department
 - College of Education
- Minnesota Economic Development Center
- Business Economic Education Foundation

The SCSU Center for Economic Education is an affiliate of the Minnesota Council on Economic Education (MCEE) and the National Council on Economic Education (NCEE). The Center offers in-service and pre-service for credit workshops, short courses, and traditional courses in the area of economics for K-12 educators. The Center also offers a variety of non-credit workshops and programs that appeal to broader audiences. In addition to the Winter Institute, the Center organizes an annual Economic Outlook program and sponsors the Minnesota Heartland Economics Challenge, an economics quiz bowl for high school students from Central Minnesota schools. The Center is also responsible for the *St. Cloud Area Quarterly Business Report*. For more information about Center programs, call our office at 320-255-2157 or write us at the address provided on the back of the brochure.

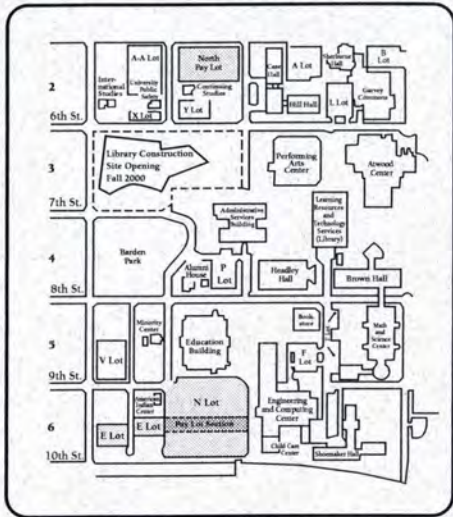

N
O
R
T
H
C
A
M
P
U
S

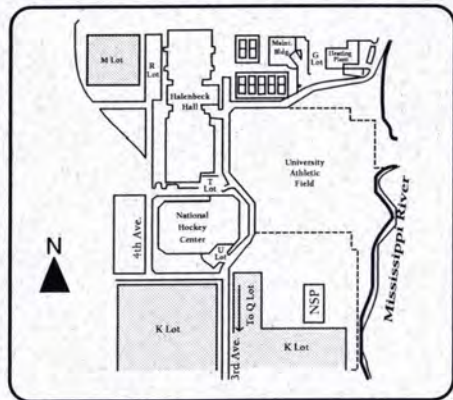

S
O
U
T
H
C
A
M
P
U
S

PARKING

Parking is available in the North Pay Lot next to the Continuing Studies building and in the Pay Lot section of N Lot, next to the Education building. Free parking is available in M Lot and K Lot (south of the National Hockey Center). The K Lot also requires a small fee for the Husky Shuttle that runs near Atwood Center. Parking is also available on public streets near campus. Please see map for more information. Parking permits are required to park in faculty, staff and student lots. Call the Center for Economic Education for more details, (320) 255-2072.

Dr. Kevin M. Murphy is the George Pratt Shultz Professor of Business Economics and Industrial Relations at the University of Chicago Graduate School of Business. He has been a member of the Chicago faculty since 1983.



Kevin M. Murphy

Professor Murphy is the recipient of numerous awards and fellowships, including a Sloan Foundation Fellowship and an Earhart Foundation Fellowship. He is a Fellow of the Econometric Society, a Faculty Research Fellow at the National Bureau of Economic Research, a member of the American Academy of Arts & Sciences, and the author of some 45 published articles. His most recent research has focused on returns to education and skill, unemployment, human capital and growth, and income inequality. Articles about Murphy's research have appeared in *The New York Times*, *The Wall Street Journal*, and many local papers.

In 1997 Murphy was the recipient of the prestigious John Bates Clark Medal, awarded every two years by the American Economics Association to the most distinguished young economist in the U.S.

Professor Murphy lives in the Chicago area. He is the president of Flossmoor Baseball & Softball, a coach and former commissioner of the Homewood-Flossmoor Soccer Club, and also sits on the Flossmoor District 161 Board of Education.

Dr. Murphy received a B.A. in economics from the University of California at Los Angeles, where he was Phi Beta Kappa, in 1981. He received a Ph.D. in economics from the University of Chicago in 1986, writing his thesis on "Specialization and Human Capital."

TTY: 1-800-627-3529 SCSU is an affirmative action/equal opportunity educator and employer. This material can be made available in an alternative format. Contact the sponsoring department.

Christopher-Farrell is co-host of *Sound Money*, a weekly one-hour personal finance call-in show produced by Minnesota Public Radio and syndicated to more than 170 markets. He is also chief economics correspondent for Minnesota Public Radio. Chris is host of *Right on the Money*, a public television personal finance program produced by Minnesota Public Television. *Right on the Money* reaches more than 65% of U.S. households, and is currently in its second season.



Chris Farrell

Chris is contributing economics editor at *Business Week* magazine. He has been associated with *Business Week* since 1986, first covering corporate finance and later economics. A frequent contributor to the magazine's extensive coverage of the economy, Chris has written numerous cover stories, including IPO Capitalism, Productivity to the Rescue, Why Are We So Afraid of Growth, What's Wrong, and the Economics of Aging. In 1994 the *Forbes Media Guide* named him one of the nation's most influential economists. Chris Farrell and a team of producers, editors and reporters received a 1999 Loeb Award for "The World Turns Upside Down," a one-hour radio documentary of the end of inflation; the team also received a Medill School of Journalism/Strong Funds Financial Writers and Editors Award.

Chris broke into journalism when he covered the markets for *Business Times* (it existed from 1983 to 1985), a pioneering business news television program carried nationally on ESPN. He also worked on *Business Times* radio, a half-hour radio show syndicated nationally on public radio. The rest of his career is eclectic. He edited *The Atlantic City Gamble*, an economic and political analysis of the gambling industry in Atlantic City; wrote articles geared toward small business for the newsletter, *Boardroom Reports*; and worked for Elliot Janeway, a financial newsletter writer. From 1976 to 1979, he worked on and off in the engine room of various merchant ships.

Chris Farrell was educated at Stanford University (B.A.) and the London School of Economics (M.A.).

REGISTRATION

No program registration fee. Luncheon costs \$7.50/reservations are required by: February 16, 2000.

Make payable to: Center for Economic Education.

Please complete this form and return by February 16, 2000.

Name: _____

Address: _____

City: _____ State _____ Zip _____

Affiliation: _____

Indicate your preference:

I plan to attend the Winter Institute and the luncheon. (Enclose \$7.50 for each luncheon reservation you desire.)

I plan to attend the Winter Institute but not the luncheon. (No registration fee.)

Total enclosed \$ _____

Please print guest names here for luncheon reservations.

Send to:

**Center for Economic Education
373 Stewart Hall
St. Cloud State University
720 Fourth Avenue South
St. Cloud, MN 56301-4498**

ST. CLOUD STATE
UNIVERSITY
A tradition of excellence and opportunity

